

TECHNICAL DATASHEET

CONDOR NYLON plug for medium loads on main construction materials

EN
rev. 12/2017
p. 1/3

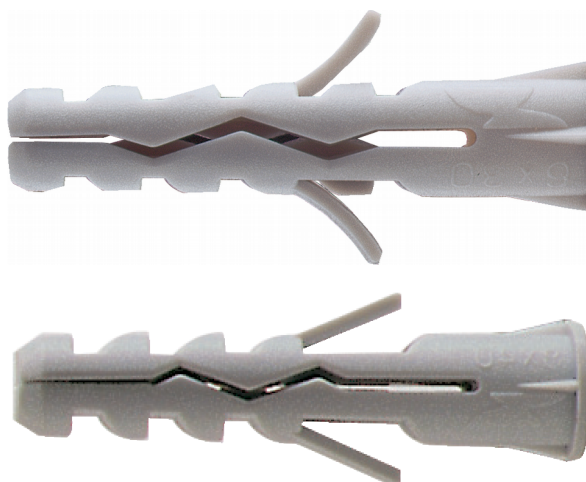

Available in two versions with and without collar

Base material

specific use	suitable use
concrete compact stone solid masonry perforated masonry	hollow masonry concrete hollow blocks AAC

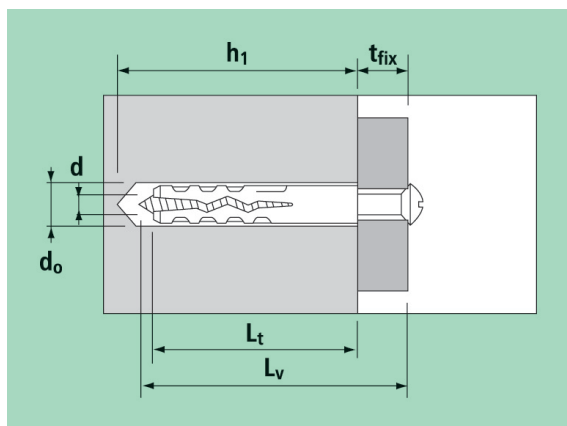

- d_0 = plug diameter = hole diameter
- L_t = plug length
- t_{fix} = fixable thickness
- h_1 = minimum hole depth
- h_{nom} = nominal embedment depth
- h_{ef} = effective anchorage depth
- d_v = screw diameter
- L_v = screw length

$$h_{nom} = h_{ef} = L_t$$

$$L_v \geq L_t + t_{fix}$$

CONDOR Nylon without collar

art.	descr.	d mm	L_t mm	h_1 mm	d_v mm
HTC04	C4	4	20	25	2 ÷ 3
HTC05	C5	5	25	35	3 ÷ 4
HTC06	C6	6	30	40	4 ÷ 5
HTC07	C7	7	30	40	4 ÷ 5.5
HTC08	C8	8	40	50	4.5 ÷ 6
HTC10	C10	10	50	60	6 ÷ 8
HTC12	C12	12	60	70	8 ÷ 10
HTC14	C14	14	80	90	10 ÷ 12

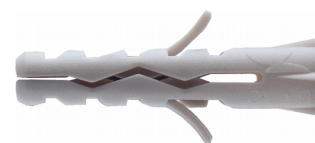

TECHNICAL DATASHEET
CONDOR NYLON plug for medium loads on main construction materials

 EN
 rev. 12/2017
 p. 2/3

CONDOR Nylon without collar
 with white zinc plated countersunk chipboard screw, cross drive

art.	descr.	d mm	L _t mm	h ₁ mm	d _v mm	L _v mm	t _{fix} mm
HTC55	C5VPS	5	25	35	4	30	5
HTC65	C6VPS	6	30	40	4,5	40	10
HTC85	C8VPS	8	40	50	5	50	10
HTC105	C10VPS	10	50	60	6	60	10

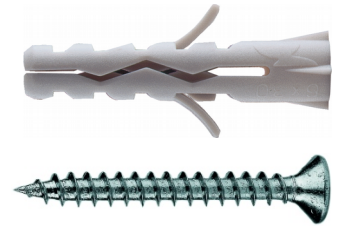

CONDOR Nylon with collar

art.	descr.	d mm	L _t mm	h ₁ mm	d _v mm
HTCB05	CB5	5	25	35	3 ÷ 4
HTCB06	CB6	6	30	40	4 ÷ 5
HTCB08	CB8	8	40	50	4.5 ÷ 6
HTCB10	CB10	10	50	60	6 ÷ 8
HTCB12	CB12	12	60	70	8 ÷ 10

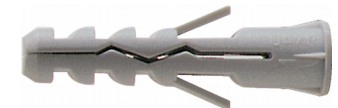

CONDOR Nylon with collar
 with white zinc plated countersunk chipboard screw, cross drive

art.	descr.	d mm	L _t mm	h ₁ mm	d _v mm	L _v mm	t _{fix} mm
HTCB55	CB5VPS	5	25	35	4	30	5
HTCB65	CB6VPS	6	30	40	4,5	40	10
HTCB85	CB8VPS	8	40	50	5	50	10
HTCB105	CB10VPS	10	50	60	6	60	10

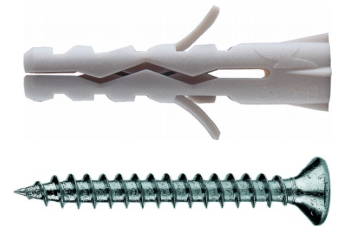
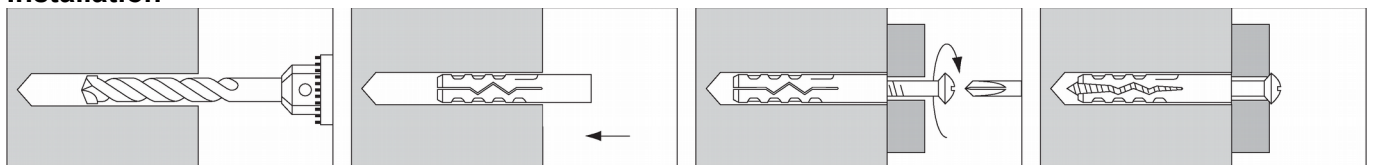
Installation

Materials

part	material	surface
plug	polyamide (Nylon) grey RAL 7035	-
screws	steel	white zinc plating ≥ 5 µm ISO 4042

TECHNICAL DATASHEET
CONDOR NYLON plug for medium loads on main construction materials

 EN
 rev. 12/2017
 p. 3/3

Strength data

in daN (1 daN ≈ 1 kg), valid for screws with the maximum recommended diameter for each size

Characteristic resistance

descr.	concrete C20/25	solid brick	hollow brick
C4	60	30	-
C5	160	60	60
C6	240	150	60
C7	280	170	60
C8	360	200	80
C10	720	280	80
C12	880	330	80
C14	1520	400	100

 Appropriate safety factor is recommended ($4 \div 5$).

Characteristic resistances derive from tests conducted in G&B Fissaggi's laboratories according to international guidelines. Load values are valid only if installation is performed accurately. Designer is responsible for the choice of size and number of anchors.

Recommended load

descr.	concrete C20/25	solid brick	hollow brick
C4	11	5	-
C5	29	11	11
C6	43	27	11
C7	50	30	11
C8	64	36	14
C10	129	50	14
C12	157	59	14
C14	271	71	18

Recommended loads include the above mentioned partial safety factor 4 and the further safety factor 1.4.